

Route inside the building

4th floor, Room B-4-300

Contact: Agnes Tan, Manager PEL
Tel: 015-278 6377 / 3068
Email: pel-io@tudelft.nl

Product Evaluation Lab

TU Delft, Faculty Industrial Design
Building 32,
Landbergstraat 15, 2628 CE, Delft

When you enter the building, you can ask for the Product Evaluation Lab (PEL) at the Service Desk on the left. The Product Evaluation Lab is where the product research will take place.

Ground Floor

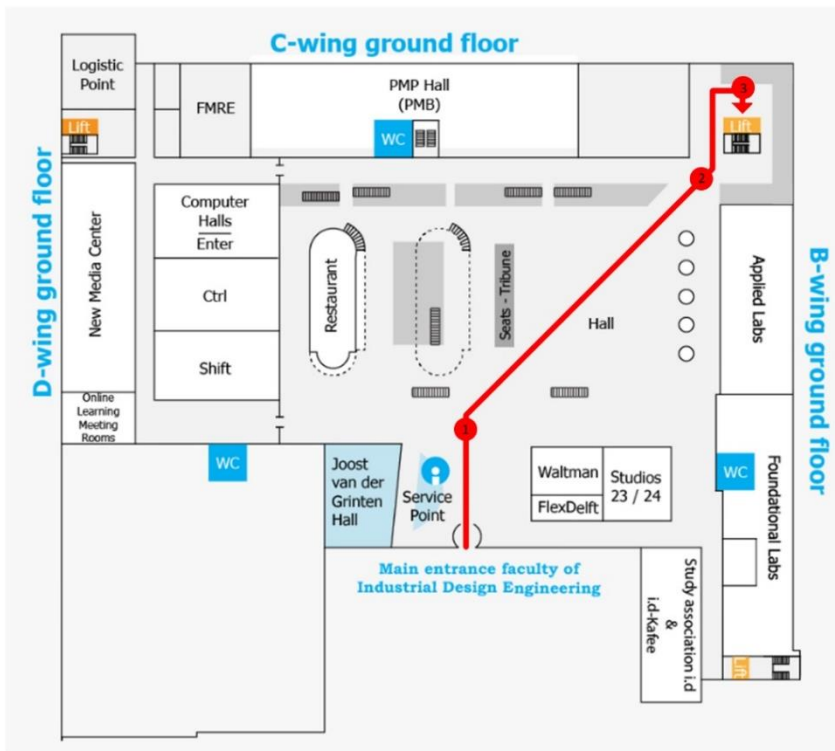

4th Floor

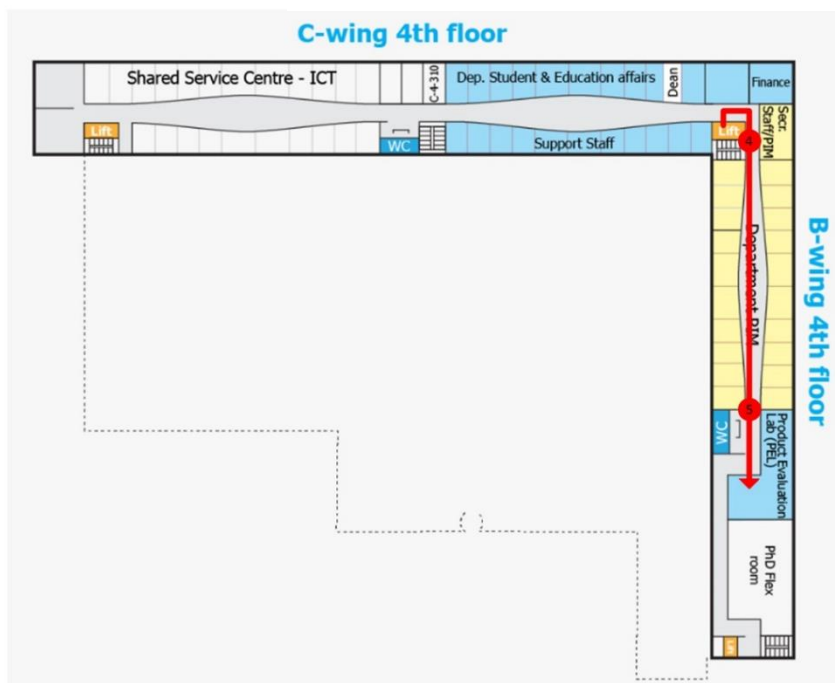

1. After you enter the building through the main doors, walk through the central hall to the right toward the back corner of the building.



2. Go left through the automatic doors.

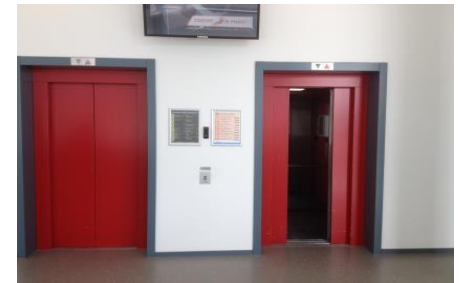

3. Go right around the corner and take the elevator to the 4th floor.



4. As you exit the elevator, go right and walk along the corridor.

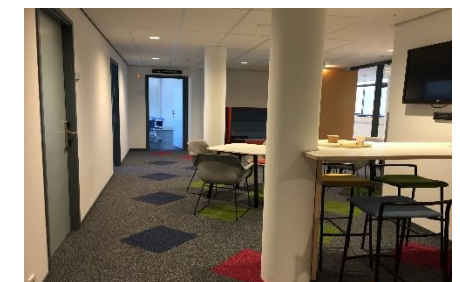

5. At the end of the corridor you will find the Product Evaluation Lab (PEL, room B-4-300) with the waiting room on the right. You can take place here.