

# Xerox® AltaLink® C8055

## User instructions

### Control panel

- 1

Startpage / home button
- 2

Active task status
- 3

Device status
- 4

Touch screen
- 5

Login - log out
- 6

Power button (on, off, energy saving)
- 7

Reset apps

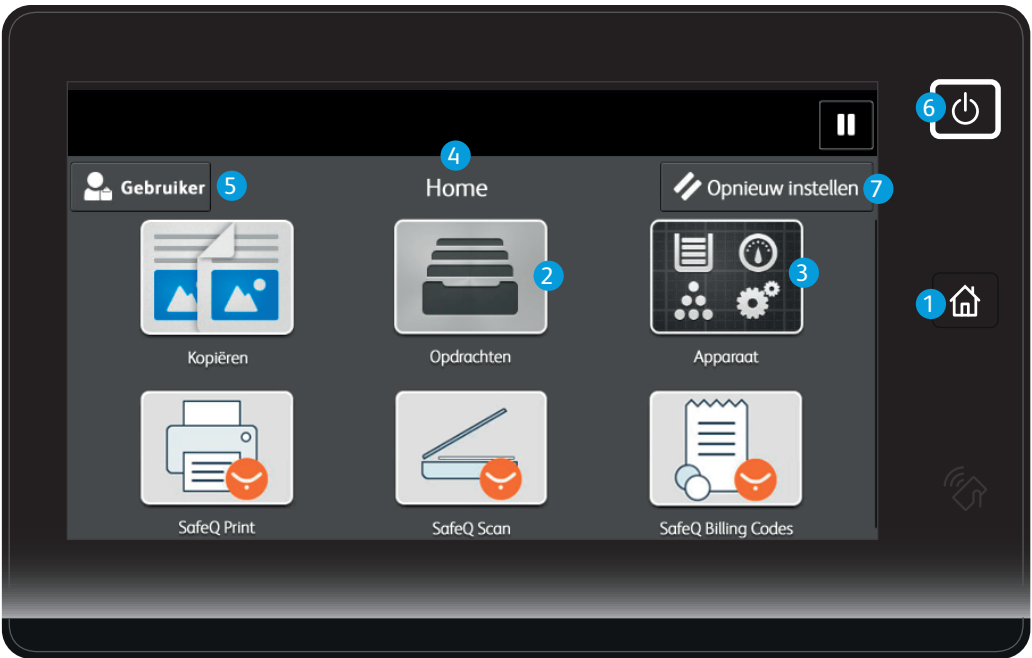

### Sign in

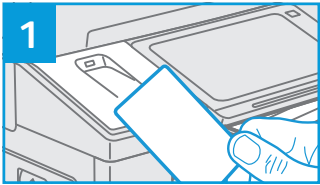

Use your TUD card and touch the card reader icon.

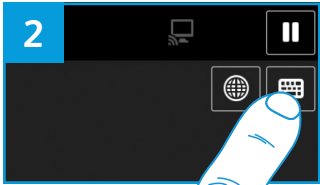

If you don't have a TUD card, select the keyboard icon

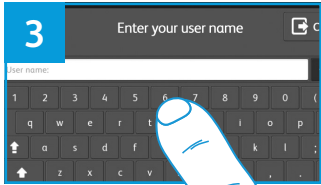

Enter your NetID and select **OK** to confirm.

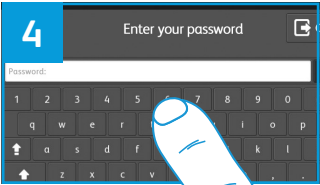

Enter your password and select **OK** to confirm.  
You are now able to use all available options.

### Sign out

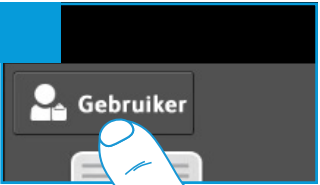

Touch the 'your name' icon.



Then select **Afmelden**.

### Copy

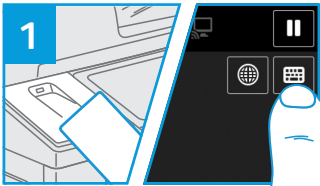

Follow the Sign in procedure as described.



Place the originals at the ADF, Automatic Document Feeder, or on the platen glass.

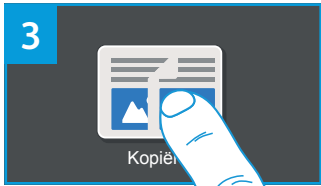

Select **Kopiëren**.

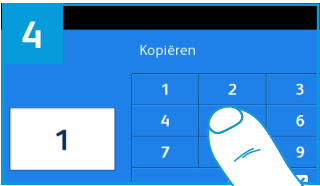

Enter the number of copies needed.

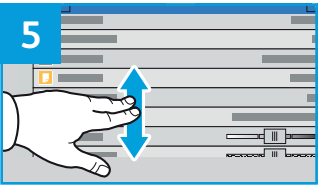

Select the options as desired.



Select **Start** to process the job

### Printing

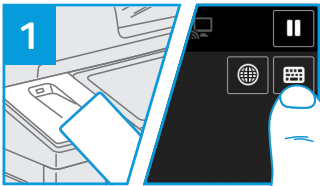

Follow the Sign in procedure as described.



Select **SafeQ Print**.

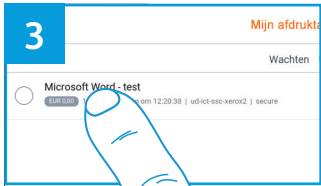

Select the print job.

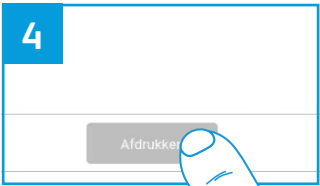

Select **Afdrukken** to activate the process.

### Scanning

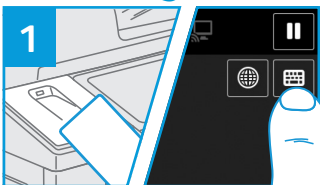

Follow the Sign in procedure as described.

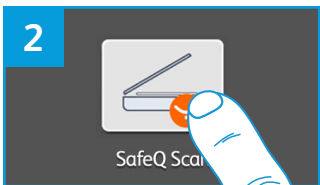

Select **SafeQ Scan**.

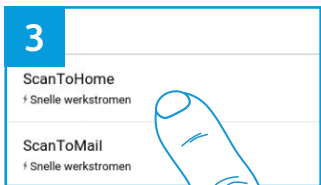

Select **ScanToHome** or **ScanToMail**.

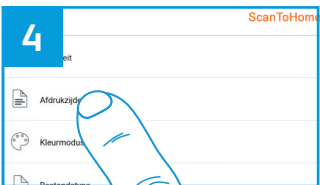

Select scan options.

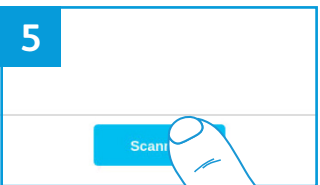

Select **Scannen** to activate the process.



©2018 Xerox Corporation. All rights reserved. Xerox®, Xerox® and Design® and AltaLink® are trademarks of Xerox Corporation in the United States and/or other countries.